

DIFFERENTIAL PRESSURE SWITCH EXPLOSION PROOF TYPE

DPS2300X

Explosion Proof Type
Protection: IP68
Adjustable Ranges: 0.1~11" W.C.
Temperature: -40 to 60°C

The New-Flow DPS2300X, an explosion proof differential pressure switch, is designed to be used in instrument air and non-corrosive, inert gases. DPS2300X has high set point repeatability and narrow dead band features. A variety of range selections are available upon request. Easily adjusted to the set point.

Technical Data

Switch Data: SPDT 15A @125, 250, 480VAC, 60Hz. Resistive 1/8 HP @125VAC; 1/4 HP @250VAC, 60Hz
Housing Material: Die cast aluminum alloy with positive electrode
Pressure Element: Silica gel diaphragm
Process Materials: Wetted parts are all in SS316
Set Point Adjustment: Screw type on top of housing c/w plug
Mounting Type: Diaphragm in vertical position
Conduit Connection: 1/2" NPT Female
Process Connection: High & Low side 1/4" NPT Female
Pressure Limit: Surge 0.7 Bar
Temperature Limit: -40~140°F (-40~60°C)
Weight: approx. 1.9 Kg

Dimensions-mm

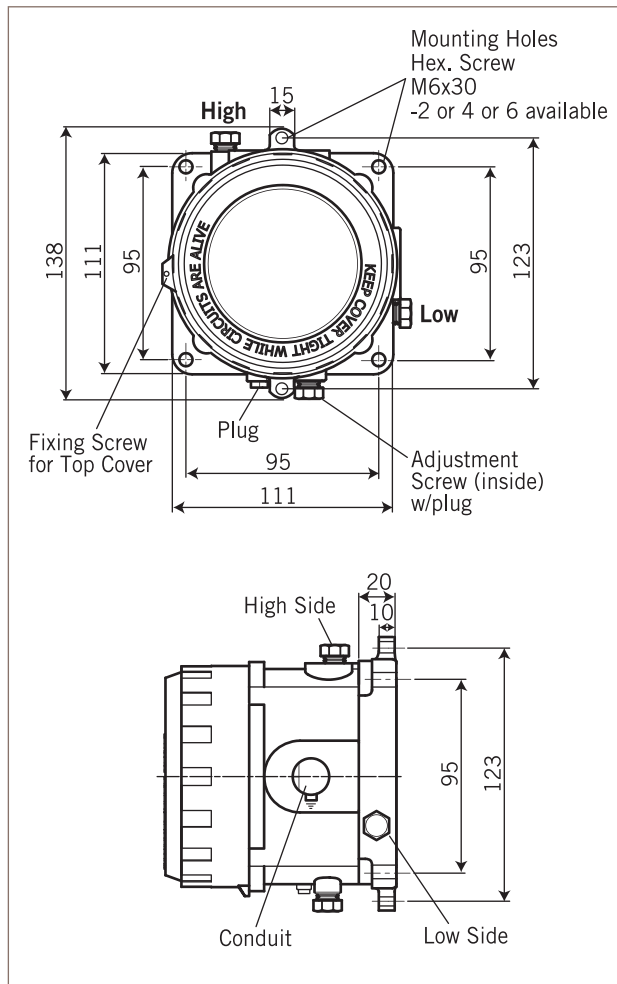

Approvals:



Switches with UL & CSA Recognized and File No. E12252.

Range Selection Table

Inch of Water ("W.C.):

Code	Adjustable Range	Dead Band	Continuous/Surge
01W	0.1~0.25" W.C	0.04 / 0.07" W.C	0.12 Bar / 0.7 Bar
02W	0.15~1.8" W.C	0.1 / 0.2" W.C	0.12 Bar / 0.7 Bar
03W	0.4~2.5" W.C	0.15 / 0.3" W.C	0.12 Bar / 0.7 Bar
04W	0.8~4" W.C	0.2 / 0.4" W.C	0.12 Bar / 0.7 Bar
05W	3~11" W.C	0.4 / 0.5" W.C	0.12 Bar / 0.7 Bar

Ordering Information

DPS2300X	Code	Range
	01W	0.1~0.25" W.C.
	02W	0.15~1.8" W.C.
	03W	0.4~2.5" W.C.
	04W	0.8~4" W.C.
	05W	3~11" W.C.

Code	Wetted Parts Material
A	SS316

Code	Process Connection (High & Low Side)
1	1/4" NPT Female
2	1/4" PT Female
3	G1/4" Female
O	Option

Code	Conduit Connection
E	1/2" NPT Female, standard
F	3/4" NPT Female
O	Option

Code	Switch Form
1	One SPDT

DPS2300X [] [] [] [] [] Complete Ordering Code