

# MAGNETIC LEVEL SWITCH

## MWS TYPE



**Approvals:**



TD0400TJ  
 工電(2016)第00114號  
 (ITRI)2017第07-00105號

Switches with UL & CSA Recognized and File No. E41515.

**Technical Data**

**Case Housing Material:** Aluminum alloy or SS316 available  
**Protection Class:** (Taiwan Explosion Proof Certification):  
 Ex d IIB + H<sub>2</sub> T6 Gb  
**Micro Switch:** SPDT x 1; SPDT x 2 (one setting point)  
**Rating:** 3A/250VAC, 5A/125VAC, 4A/30VDC  
**Extension Wire Connection:** Female 1/2", 3/4"NPT, PF or BSP available

**Dimensions**

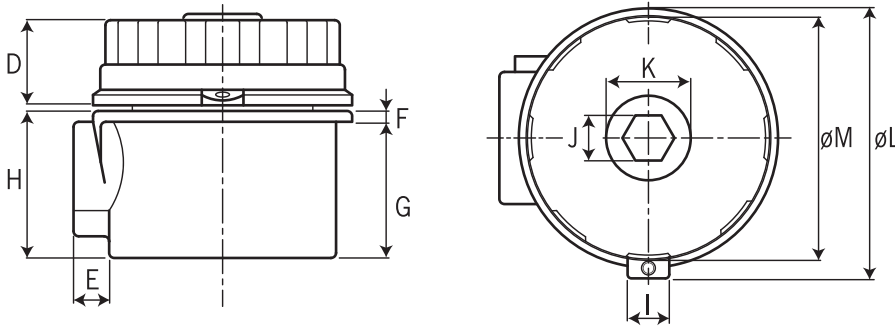

Type	Dimensions									
	D	E	F	G	H	I	J	K	øL	øM
MWS	33	13.8	4.2	52.8	57	13.5	17.5	32.8	102.8	94.5

unit:mm

**Wire Drawing**

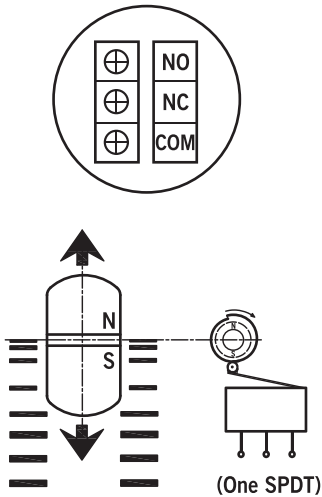

(Two SPDT)

NC	6
NO	5
COM	4
NC	3
NO	2
COM	1

Option: 2 SPDT switch on request

**Ordering Information**

MWS	Code	Case Material								
↓	A	Aluminum alloy								
	B	SS316								
↓	Code	Switch Function- Micro Switch								
	1	One Switch (SPDT x 1)								
↓	2	Two Switches (SPDT x 2)								
	Code	Conduit Size								
↓	(1)	1/2"NPT(F) (2) 3/4"NPT(F) (3) 1/2"PF(F) (4) 3/4"PF(F)								
	(5)	1/2"BSP(F) (6) 3/4"BSP(F) (7) Option								
↓	Code	Explosion Proof Type / Housing Material								
	B	(Taiwan Explosion Proof Certification) / Aluminum alloy Ex d IIB + H <sub>2</sub> T6 Gb								
	B1	(Taiwan Explosion Proof Certification) / SS316 Ex d IIB + H <sub>2</sub> T6 Gb								
MWS										Complete Ordering Code