

# PRESSURE REDUCING REGULATOR

## PRU100

### Technical Data

For using gas and liquid  
**Inlet pressure:** 600, 3500 Psig maximum  
**Adjustable outlet pressure in ranges:** 20, 50, 100, 150, 250, 500 Psig  
**Operating temperature:** -60 to 150°C  
**Diaphragm material:** 316L stainless steel  
**Body material:** 316L stainless steel  
**Seat material:** Teflon, PFA, and Special Teflon Seat available  
**CV flow coefficients:** 0.06  
**Process connection:** ¼" NPT female  
**Two gauge connection ports are:** ¼" NPT female  
 Use no oil: available



Plastic Knob



Metal Knob

Approvals:

CE 1128

### Standard Port Configuration

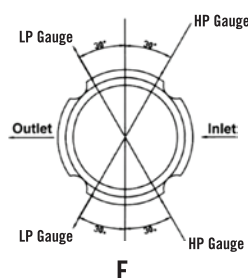
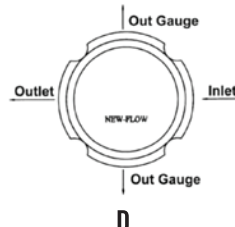
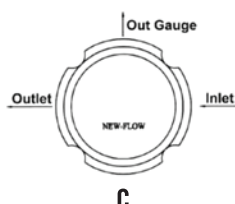
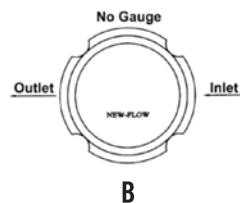
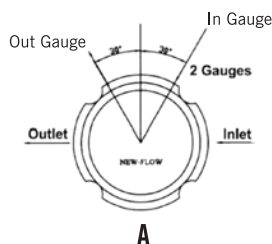

### Dimensions

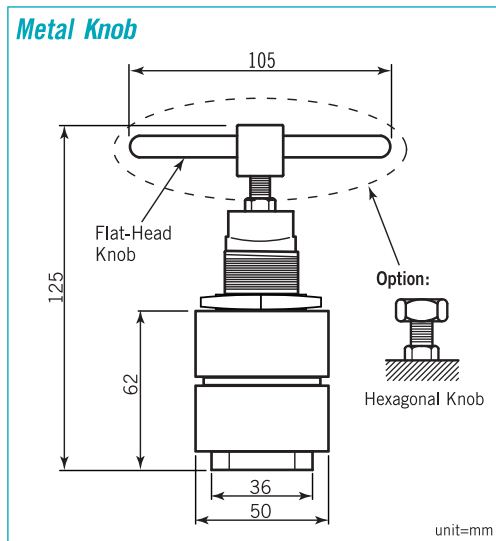
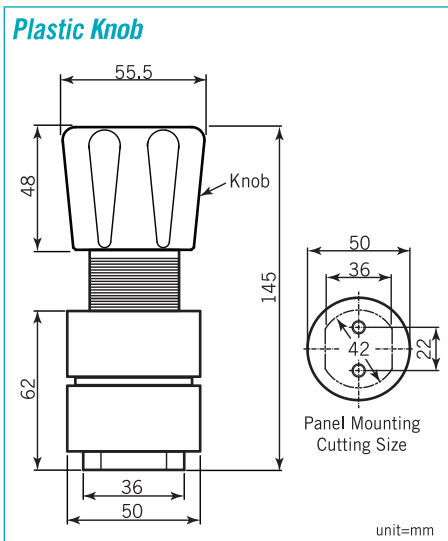

### Ordering Information

PRU100	<b>Code</b>	<b>Body Material</b>											
	1	316L Stainless Steel											
	A	<b>Code</b>		<b>Knob Material</b>									
		A	Plastic	B	Metal (Flat-Head)	C	Metal (Hexagonal)						
		<b>Code</b>	<b>Max. Inlet Pressure</b>										
	1	600 Psig											
	2	3500 Psig											
	4	<b>Code</b>		<b>Outlet Pressure Range</b>									
		1	1-20 Psig	2	1-50 Psig	3	2-100 Psig						
		4	2-150 Psig	5	3-250 Psig	6	5-500 Psig						
A	<b>Code</b>	<b>Seat Material / Max. Inlet Pressure / Temp. Limit</b>											
	A	Teflon / 600 Psig / -20°C~+80°C											
	B	PFA / 3500 Psig / -20°C~+150°C											
C	Special Teflon Seat / 3500 Psig / -60°C~+80°C												
A	<b>Code</b>		<b>Port Configuration</b>										
	A	B	C	D	E								
<table border="1"> <tr> <td>PRU100</td> <td></td> <td></td> <td></td> <td></td> <td></td> <td></td> <td>Complete Ordering Code</td> </tr> </table>						PRU100							Complete Ordering Code
PRU100							Complete Ordering Code						